

**INSTALL INTERIOR HANDLE ON OPERATING UNITS**

See figure to left. Install the window handle into the three holes prepped in the sash having the handle pointing towards the floor. Turn the handle 90 degrees as this will unlock the sash. Turn the cover to allow access to the screw locations on the handle. Install the two M5 x 50mm flat head machine screws provided with the handle. The screws thread into the espagnolette gear casing and fasten with a phillips screwdriver.

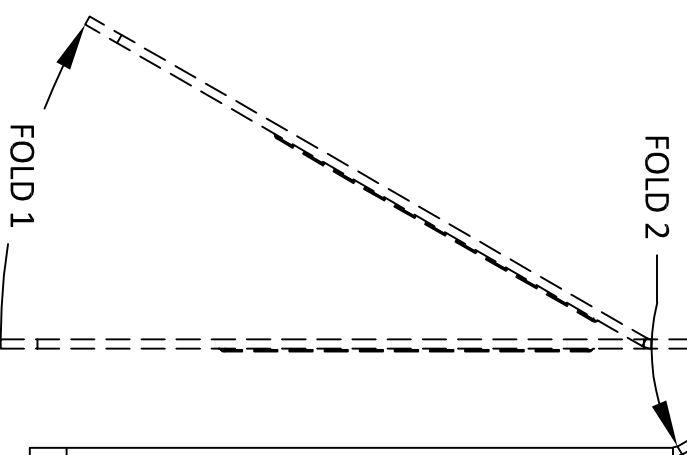
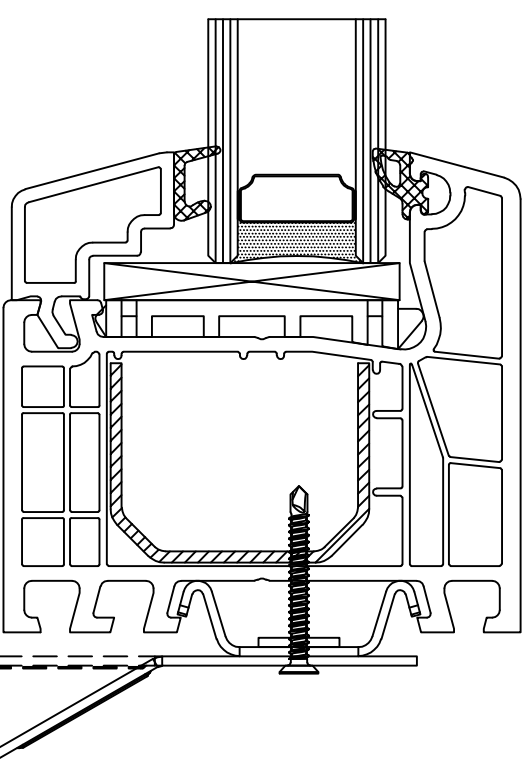
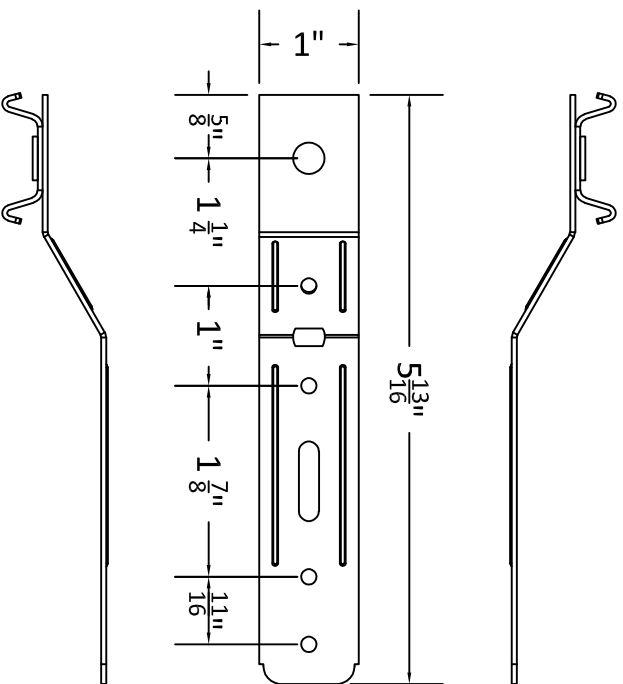

**ADJUSTING HINGES**

See figures below. After the window is installed test the window function. If adjustments are needed open the window and adjust the top stay bearing with an allen wrench or the bottom pivot rest as needed.

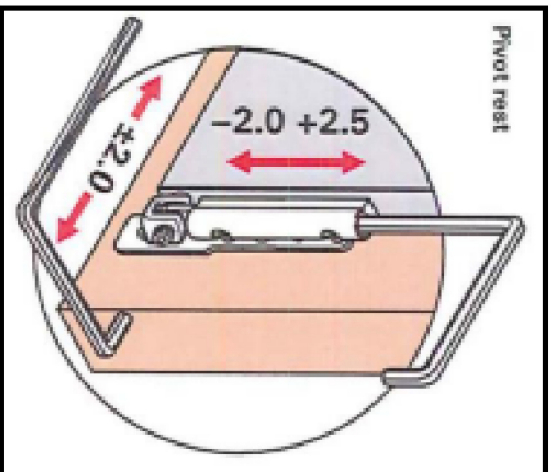
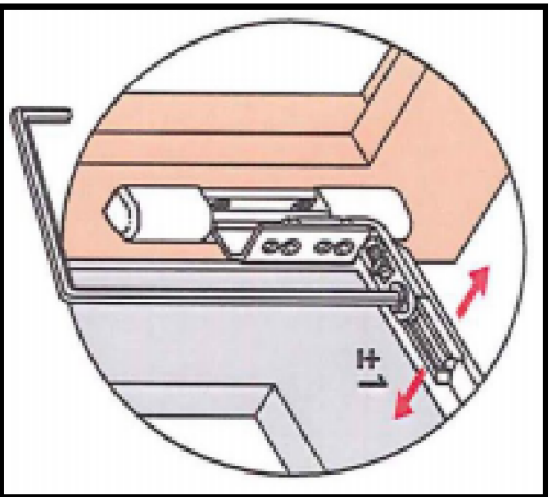
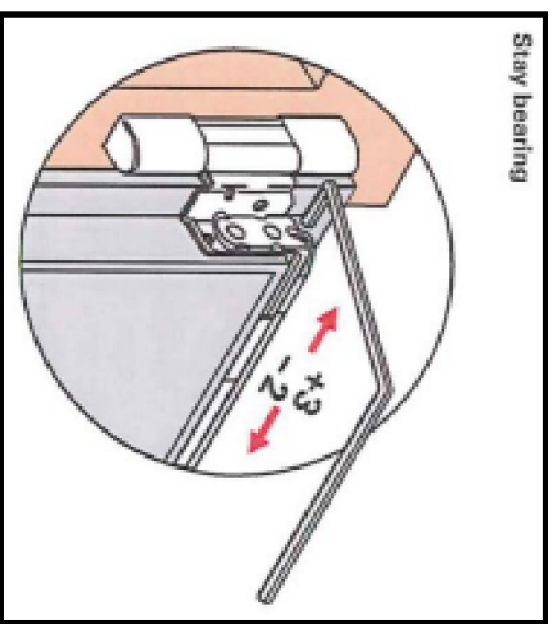

ECO WINDOWS, LLC.

PHONE 775.636.8138  
 FAX 775.636.8391  
 WWW.ECOWDS.COM  
 EMAIL INFO@ECOWDS.COM

TITLE: INSTALLATION DETAILS

SUBMITTAL DRAWINGS

PROJECT: ----

ARCHITECT: ----

CONTRACTOR: ----

SCALE: N.T.S.

DATE: MM.DD.YYYY

REVISIONS:

